

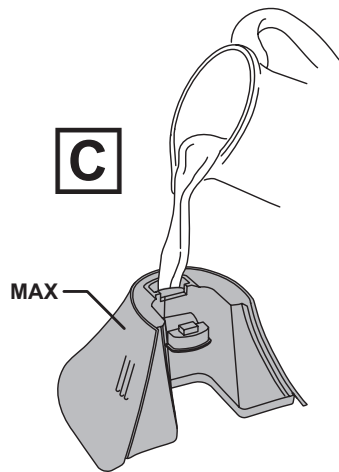

Russell Hobbs

A BRITISH ICON SINCE 1952

28550

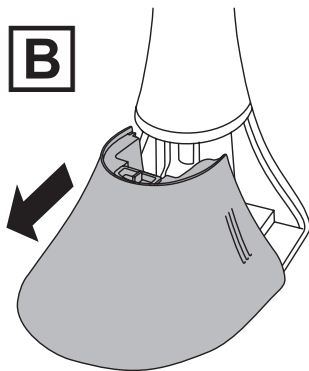
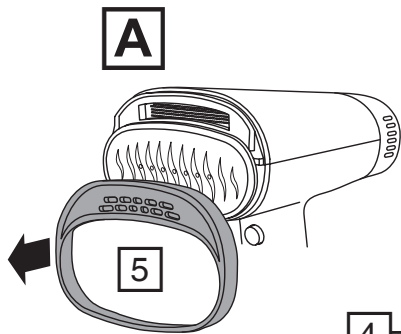
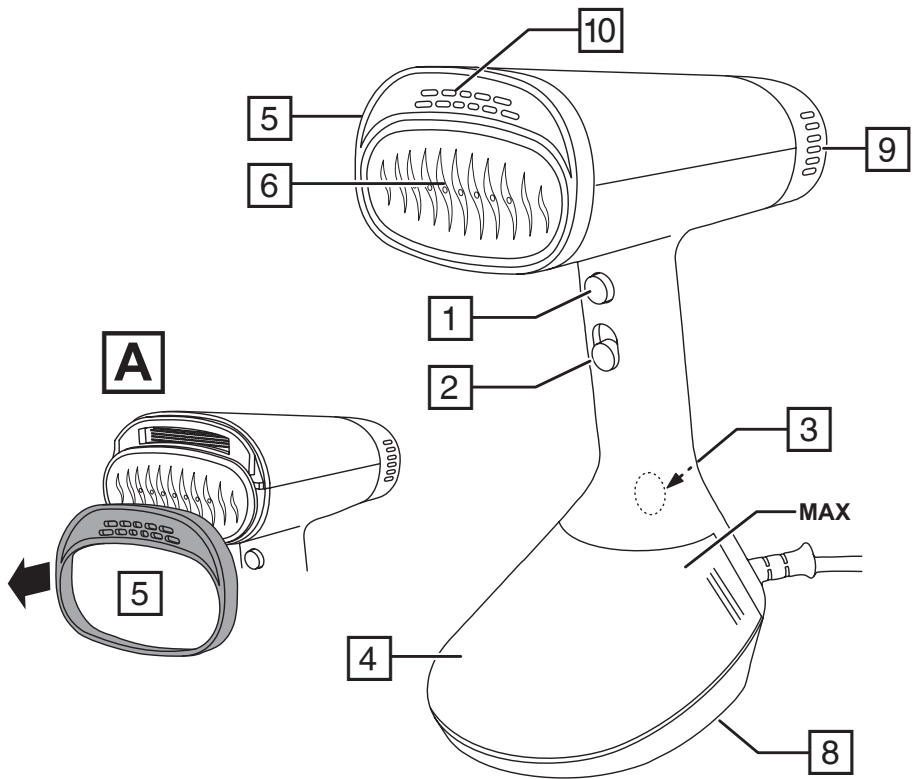

Read the instructions, keep them safe, pass them on if you pass the appliance on. Remove all packaging before use.

IMPORTANT SAFEGUARDS

Follow basic safety precautions, including:

This appliance can be used by children aged from 8 years and above and persons with reduced physical, sensory or mental capabilities or lack of experience and knowledge if they have been supervised/ instructed and understand the hazards involved. Children shall not play with the appliance. Cleaning and user maintenance shall not be done by children unless they are older than 8 and supervised. Use and store the appliance out of reach of children under 8 years. Between uses, the steamer must be rested on a stable, level, heat-resistant surface.

Don't leave the appliance unattended while plugged in, or while it's resting between uses.

Unplug the appliance before filling, before cleaning, and after use.

Don't operate the appliance if it's dropped or damaged, or if it malfunctions or leaks.

The plug must be removed from the socket-outlet before the water reservoir is filled with water.

When placing the iron on its stand, ensure that the surface on which the stand is placed is stable.

Keep the iron and its cord out of reach of children less than 8 years of age when it is energized or cooling down.

Care should be taken when using the appliance due to the emission of steam.

If the supply cord is damaged, it must be replaced by the manufacturer, its service agent or similiary qualified persons in order to avoid a hazard.

 The surfaces of the appliance will get hot during use.

 Do not immerse in any liquid.

- Never use anything except water to fill or clean the appliance.
- Never steam clothing that is being worn.
- Never aim steam directly at people, animals or plants. Steam is hot and can cause serious burns and scalds if used without care.
- Never hold the steam head downwards while at rest, or tilt it backwards as this may cause hot water to be discharged and possible injury.
- Ensure the appliance is switched off and cooled down before fitting or removing attachments.
- Don't use the appliance for any purpose other than those described in these instructions.

HOUSEHOLD USE ONLY

PARTS

- | | |
|--------------------|---|
| 1. Steam trigger | 6. Ceramic heated press plate |
| 2. Setting control | 7. Cleaning brush (not shown) |
| 3. Power button | 8. Cleaning brush compartment (not shown) |
| 4. Water tank | 9. Outlet grille |
| 5. Filter cover | 10. Air inlet |

BEFORE USING FOR THE FIRST TIME

- Remove labels, stickers and packaging from the appliance.
- Read all instructions and warnings.
- Note: Any water droplets or condensation inside the water tank are a result of quality testing prior to shipping.



IMPORTANT INFORMATION

- For best performance, we recommend using distilled, purified or filtered water in your steamer. Tap water contains minerals that can build up inside your steamer over time and reduce its efficiency or even cause damage.
- Never use perfumes, oils or other additives.
- Always check the garment's care label before steaming, and always test fabrics for colourfastness in an inconspicuous area. Steamers are not recommended for use on leather, suede, vinyl, plastic, or other materials that are sensitive to steam.
- It is normal to feel or hear the water pump inside the device. It may become louder when the water level in the tank is low. Check and refill the tank when required.
- Small amounts of dripping might occur during use. If excessive, your steamer needs time to get back up to full temperature. Just allow the steamer a minute to reheat.
- Wearing clothes immediately after ironing or steaming can actually create wrinkles. Always allow the clothing to cool for about 5 minutes before wearing.

FILLING

1. Place the steamer on its base on a stable surface.
2. Pull out the removable water tank (Fig. B)
3. Gently open the rubber cover at the top of the tank.
4. Fill until the water reaches the "MAX" level mark on the side of the tank (Fig. C). Do not overfill. Close the rubber cover securely.
5. Dry off any excess water from the tank then refit it into the base until it clicks.
- To refill at any time during use, turn the steamer off by pressing the power button until the blue indicator light goes out, unplug from outlet, and follow the above procedure.
- After refilling, allow to reheat for 35 seconds and then prime the pump by holding the steam trigger until steam forms.

USING

- If the label says “do not iron” or shows this icon , make sure to test on an inconspicuous area prior to steaming the entire garment.
 - If the label says “do not steam” or shows this icon , do not steam the garment.
1. Hang the garment in an area that will not be affected or damaged by the heat and steam, such as on a shower curtain rail, or in an open doorway.
 2. Plug the steamer in then press the power button. The power button light will slowly flash, indicating that the steamer is heating.
 3. After about 35 seconds the power light will stay on, indicating the steamer is preheated.

Note: If you use the steamer in steam-only mode, condensation can build up inside the steamer head. This condition is normal. To reduce condensation, operate the steamer in VacuSteam High mode.

VacuSteam™ Technology

Our innovative VacuSteam™ Technology holds the fabric in place maximising the suction and steam.

4. Select the desired setting using the setting switch.

Note: When using setting Low or High the steamer will produce a noise when it is operating this is normal.

POSITION	USE
OFF	Vacuum off, steam only
LOW	Vacuum low - perfect for any delicate fabrics
HIGH	Vacuum high - perfect for tougher creases

5. Prime the water pump by holding steam trigger until steam forms.
6. To generate steam, press the steam trigger. As long as the trigger is held, steam will emit from the steamer. When the trigger is released, the steam will stop.
7. With your free hand keep the fabric taut. Steam the garment with slow, downward strokes. When the Vacuum in low or high setting is operated the suction will gently pull the fabric towards the steamer plate and hold it in place allowing you to remove creases in one pass.
8. When you have finished, press and hold the power button until the blue light goes out (about 3 seconds) and unplug.
9. Stand the steamer on its base and allow it to completely cool off before storing. To avoid mineral buildup, empty the tank after each use.

Auto shut off

Your steamer will automatically switch to auto shut-off mode after being left inactive for 8 minutes. The power button light will flash rapidly to indicate this. To resume steaming, press the steam trigger or power button and wait for your steamer to fully reheat.

CARE AND MAINTENANCE

1. Make sure steamer is off, unplugged and completely cool.
2. Wipe all surfaces with a clean damp cloth.
3. Pull the filter cover away from the front of the steamer and use the supplied cleaning brush to remove any debris or lint that may have built up during use.
4. Replace the filter cover.
5. After the steamer has been thoroughly dried, turn it back on and lightly steam over an old cloth. This will help remove any residue left in the steam holes.
6. To avoid mineral buildup, empty the tank after each use.
7. Store your cleaning brush in the compartment under the base.
8. We recommend cleaning the filter before every use to maintain peak suction performance.

TROUBLESHOOTING

Problem	Possible Cause	Solution
The steamer is plugged in but not heating.	The auto shut-off has activated.	Press the steam trigger or press the power button to activate the steamer.
Not enough steam or no steam is coming out of the steamer.	The steamer is not heated to full temperature.	Always allow steamer to preheat at least 35 seconds, or until the power button light stops flashing.
	There is not enough water in the water tank.	Fill the water tank.
	The water pump hasn't been primed.	After preheating, always prime the water pump by holding the steam trigger until steam forms.
Discoloured water is coming through the holes and staining the fabric.	Residue has built up in the water tank.	Empty the water tank after each use. Only use distilled, filtered, or purified water.
	Perfumed or scented additives were used.	Never use perfumed or scented additives.
Steamer is leaking or spitting.	Steamer is not hot enough.	Allow the steamer to heat for about 35 seconds.
	Water tank is running low.	Fill the water tank.
There is a reduction in suction	There is lint and build up in the filter.	Use the cleaning brush supplied and clean the filter.

RECYCLING



To avoid environmental and health problems due to hazardous substances, appliances and rechargeable and non-rechargeable batteries marked with one of these symbols must not be disposed of with unsorted municipal waste. Always dispose of electrical and electronic products and, where applicable, rechargeable and non-rechargeable batteries, at an appropriate official recycling/collection point.

SERVICE

If you ring Customer Service, please have the Model Number to hand, as we won't be able to help you without it. It's on the rating plate (usually underneath the product).

The product isn't user-serviceable. If it's not working, read the instructions, check the plug fuse and main fuse/circuit breaker. If it's still not working, consult your retailer.

If that doesn't solve the problem – ring Customer Service – they may be able to offer technical advice.

If they advise you to return the product to us, pack it carefully, include a note with your name, address, day phone number, and what's wrong. If under guarantee, say where and when purchased, and include proof of purchase (till receipt). Send it to:

Customer Service

Spectrum Brands (UK) Ltd

Fir Street, Failsworth, Manchester M35 0HS

email: support@russellhobbs.com

telephone: 0345 658 9700 (local rate number)

Please note: If you have purchased the product within the last 6 months, please contact the retailer in the first instance to deal with any matters relating to warranty.

GUARANTEE

Defects affecting product functionality appearing within the guarantee period will be corrected by replacement or repair at our option provided the product is used and maintained in accordance with the instructions. Your statutory rights are not affected.

This warranty shall not be valid where it is contrary to U.S. and other applicable laws, or where the warranty would be prohibited under any economic sanctions, export control laws, embargos, or other restrictive trade measures enforced by the United States or other applicable jurisdictions. This includes, without limitation, any warranty claims implicating parties from, or otherwise located in, Cuba, Iran, North Korea, Syria and the Crimea region.

Guarantee period = 2 years from first retail purchase.

To claim an extra 1 year guarantee, register your product online within 28 days of purchase. Register at: **uk.russellhobbs.com/product-registration**

Consumables are guaranteed only for their recommended lifecycle. Replacement/Spare parts* are excluded and are only covered by a 1 year warranty.

* Examples include filters, removable grill plates, drip trays/crumb trays etc.



www.russellhobbs.com for more products

