



Russell Hobbs



22630

 www.russellhobbs.com

Register online for an EXTRA year guarantee

Visit www.russellhobbs.co.uk/productregister/ You must register within 28 days of purchase

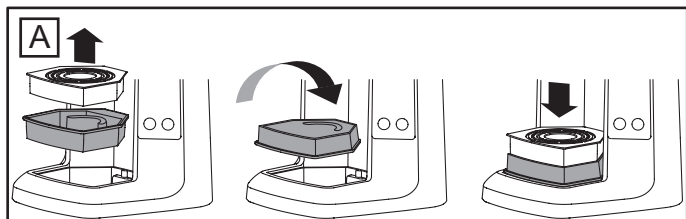
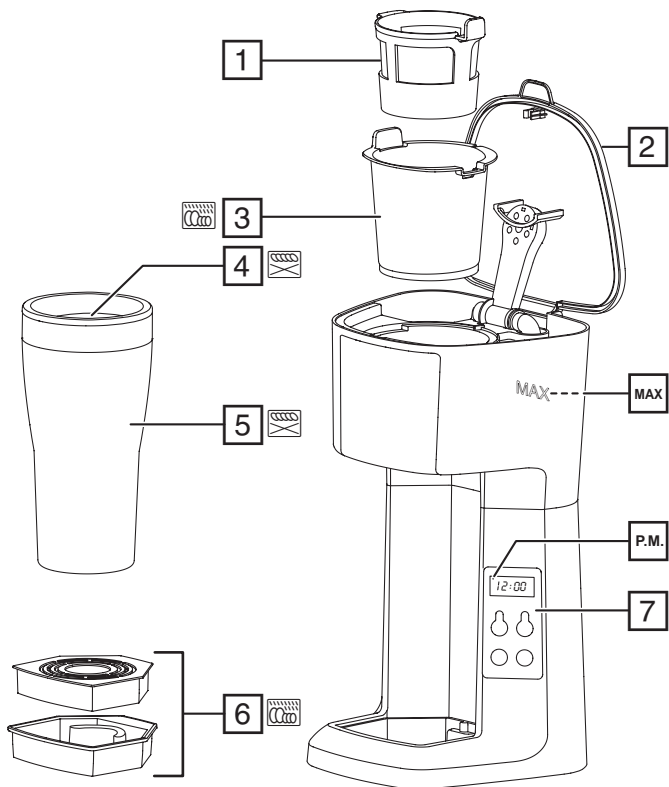

Read the instructions, keep them safe, pass them on if you pass the appliance on.
Remove all packaging before use.

IMPORTANT SAFEGUARDS

Follow basic safety precautions, including:

This appliance can be used by children aged from 8 years and above and persons with reduced physical, sensory or mental capabilities or lack of experience and knowledge if they have been supervised/instructed and understand the hazards involved.

Children shall not play with the appliance.

Cleaning and user maintenance shall not be done by children unless they are older than 8 and supervised.

Keep the appliance and cable out of reach of children under 8 years.

Misuse of the appliance may cause injury.

 The surfaces of the appliance will get hot. Residual heat will keep the surfaces hot after use.

The coffee-maker shall not be placed in a cabinet when in use.

If the cable is damaged, it must be replaced by the manufacturer, its service agent, or someone similarly qualified, to avoid hazard.

The surface of the heating element is subject to residual heat after use.

Use the appliance according to these instructions. Any misuse may cause potential injury, electric shock or other hazards.

This appliance can be used by persons with reduced physical, sensory or mental capabilities or lack of experience and knowledge if they have been given supervision or instruction concerning use of the appliance in a safe way and understand the hazards involved.

This appliance is intended to be used in household and similar applications such as:

- staff kitchen areas in shops, offices and other working environments;
 - by clients in hotels, motels and other residential type environments;
 - bed and breakfast type environments;
 - farm houses.
- ⊗ Do not use this appliance near bathtubs, showers, basins or other vessels containing water.
- Sit the appliance on a stable, level, heat-resistant surface.
 - Keep the appliance and cable away from the edges of worktops.
 - Don't use accessories or attachments other than those we supply.
 - Don't use the appliance for any purpose other than those described in these instructions.
 - Don't use the appliance if it's damaged or malfunctions.

PARTS

- | | |
|---------------------------|------------------|
| 1. Permanent filter | 5. Travel mug |
| 2. Lid | 6. Drip tray |
| 3. Filter holder | 7. Control panel |
| 4. Lid with sliding cover | |

BEFORE USING FOR THE FIRST TIME

Fill the reservoir to the **max** mark, and run the appliance without coffee.

SET THE CLOCK

1. Put the plug into the power socket.
2. 12:00 will blink on the display.
3. Set the clock to the correct time.
 - Use the **h** and **min** buttons to set the correct hour and minute.





A small dot in the display indicates **PM**.

The clock will retain its settings until the coffee maker is unplugged.

MAKING COFFEE

1. Open the lid.
2. Pour fresh cold water into the reservoir up to MAX mark using the travel mug. If you are using a regular coffee mug or cup, use the cup itself to fill the reservoir. Never fill the reservoir past the MAX mark.
3. Close the lid
4. Add sweetener, cream or milk to the travel mug or cup as desired.
5. Fit the permanent filter into the filter holder.
6. For the travel mug, put approximately 20-25g of ground filter coffee into the filter. For a regular mug or cup (235 ml), use approximately 10-12g of coffee.
7. Place the travel mug or cup under the coffee maker. If using the travel mug, ensure that the sliding cover in the lid is in the open position. The tray can be adjusted in height if you are using a regular cup (FIG A). Ensure the drip tray is securely in place before brewing.
8. Put the plug into the power socket (switch the socket on, if it's switchable).
9. Press the ☕ switch. The light will come on. The coffeemaker and ☕ light turn off automatically when brewing is finished. Allow coffee to finish dripping from the unit before removing the travel mug or cup. Do not remove your mug while coffee is brewing.
10. To cancel brewing, press the ☕ button.

USING THE TIMER

1. Set the timer to the time you want to start brewing.
 - Press and hold the /AUTO button for 3 seconds. The /AUTO light will start flashing.
 - Use the **h** and **min** buttons to set the correct hour and minute.
 - Once the desired time is displayed press the /AUTO button again. The /AUTO light will stop flashing and stay on. This indicates the time is set.
2. At the time you set, your coffee maker will start up.
3. To cancel the timer before brewing has started, press the /AUTO button again.

NOTES

- Don't be tempted to reheat coffee in the appliance. You'll damage the appliance and the coffee will be undrinkable.
- Clean the filter holder after each use. Residue from a previous brew will spoil your coffee.
- The time will need to be reset if the unit is unplugged or power is interrupted.
- Be careful when opening the cover after brewing as this area is hot and steamy. Use the lift tab located on the front of the lid.

CARE AND MAINTENANCE

1. Unplug the appliance and let it cool.
2. Tip the contents of the filter holder into the bin.
3. Clean the outside surfaces of the appliance with a damp cloth.
4. You may clean the travel mug, permanent filter and filter holder in warm soapy water. Rinse thoroughly afterwards, to remove all traces of soap.



You may wash these parts in a dishwasher.



You may wash these parts in the top rack of a dishwasher.

DESCALE REGULARLY

Descale the appliance at least monthly with a proprietary descaler. Follow the instructions on the package of descaler.

Products returned under guarantee with faults due to scale will be subject to a repair charge.

RECYCLING



To avoid environmental and health problems due to hazardous substances, appliances and rechargeable and non-rechargeable batteries marked with one of these symbols must not be disposed of with unsorted municipal waste. Always dispose of electrical and electronic products and, where applicable, rechargeable and non-rechargeable batteries, at an appropriate official recycling/collection point.

SERVICE

If you ring Customer Service, please have the Model Number to hand, as we won't be able to help you without it. It's on the rating plate (usually underneath the product). The product isn't user-serviceable. If it's not working, read the instructions, check the plug fuse and main fuse/circuit breaker. If it's still not working, consult your retailer. If that doesn't solve the problem – ring Customer Service – they may be able to offer technical advice.

If they advise you to return the product to us, pack it carefully, include a note with your name, address, day phone number, and what's wrong. If under guarantee, say where and when purchased, and include proof of purchase (till receipt). Send it to: Customer Service, Spectrum Brands (UK) Ltd, Fir Street, Failsworth, Manchester M35 0HS

email: support@russellhobbs.com

telephone: 0345 658 9700 (local rate number)

Please note: If you have purchased the product within the last 6 months, please contact the retailer in the first instance to deal with any matters relating to warranty.

GUARANTEE

Defects affecting product functionality appearing within the guarantee period will be corrected by replacement or repair at our option provided the product is used and maintained in accordance with the instructions. Your statutory rights are not affected.

This warranty shall not be valid where it is contrary to U.S. and other applicable laws, or where the warranty would be prohibited under any economic sanctions, export control laws, embargos, or other restrictive trade measures enforced by the United States or other applicable jurisdictions. This includes, without limitation, any warranty claims implicating parties from, or otherwise located in, Cuba, Iran, North Korea, Syria and the Crimea region.

Guarantee period = 2 years from first retail purchase.

To claim an extra 1 year guarantee, register your product online within 28 days of purchase. Register at: **uk.russellhobbs.com/product-registration**

Consumables are guaranteed only for their recommended lifecycle. Replacement/ Spare parts* are excluded and are only covered by a 1 year warranty.

* Examples include filters, removable grill plates, drip trays/crumb trays etc.

 **ONLINE**

www.russellhobbs.com for more products