



Russell Hobbs



25920

 www.russellhobbs.com

Register online for an EXTRA year guarantee

Visit uk.russellhobbs.com/product-registration You must register within 28 days of purchase

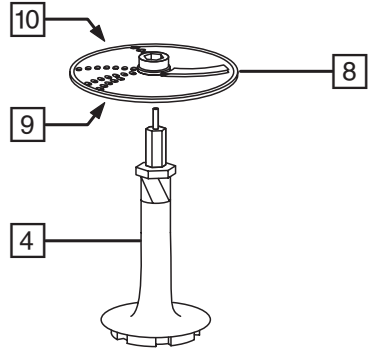
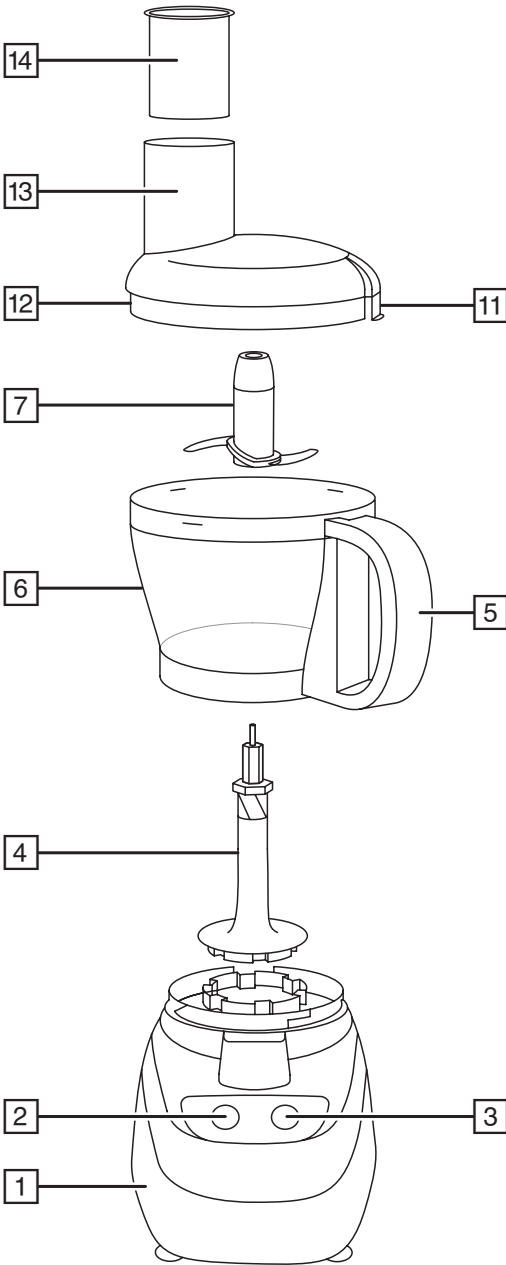



Read the instructions, keep them safe, pass them on if you pass the appliance on. Remove all packaging before use.

IMPORTANT SAFEGUARDS

Follow basic safety precautions, including:

This appliance can be used by persons with reduced physical, sensory or mental capabilities or lack of experience and knowledge if they have been supervised/instructed and understand the hazards involved. Children must not use or play with the appliance. Keep the appliance and cable out of reach of children.

 To avoid injury, take care handling the blades, emptying the jug, and cleaning.

 Don't add hot liquid (over 40°C), as it may be ejected due to sudden steaming.

Misuse of the appliance may cause injury.

Unplug the appliance before assembly, disassembly, or cleaning.

Don't leave the appliance unattended while plugged in.

If the cable is damaged, it must be replaced by the manufacturer, its service agent, or someone similarly qualified, to avoid hazard.

- Don't put the motor unit in liquid.
- Switch off (0) before fitting the jug to the motor unit.
- Switch off (0), and wait till the blades come to a stop before removing the lid from the jug, or removing the jug from the motor unit.
- Don't put utensils into the jug while the appliance is plugged in.
- Don't use accessories or attachments other than those we supply.
- Don't use the appliance for any purpose other than those described in these instructions.
- Don't operate the appliance if it's damaged or malfunctions.
- Don't run the motor continuously for more than 1½ minutes, it may overheat. After 1½ minutes switch off for at least 2 minutes, to recover.

HOUSEHOLD USE ONLY

PARTS

- | | |
|--------------------------|-------------------|
| 1. Motor unit | 8. Disc |
| 2. Off/pulse | 9. Slicing |
| 3. Continuous processing | 10. Grating |
| 4. Spindle | 11. Safety switch |
| 5. Handle | 12. Lid |
| 6. Jug | 13. Tube |
| 7. Chopper | 14. Pusher |

BEFORE USING FOR THE FIRST TIME

Turn to “CARE AND MAINTENANCE” and clean the appliance, to remove manufacturing dust, etc.

PREPARATION

1. Sit the motor unit on a stable, level surface.
 2. Fit the spindle to the top of the motor unit.
 3. Sit the jug on the motor unit, with the handle to the right of the controls.
 4. Turn the jug clockwise to bring the handle between the controls.
-

FIT THE ACCESSORY

To process, fit the chopper over the pillar in the centre of the jug and turn it anti-clockwise to lock it in place.

To remove the chopper, turn it clockwise, and lift it out of the jug.

To grate or slice:

1. Lower the disc over the top of the spindle.
 2. To slice, the slicing blade must be on top of the disc.
 3. To grate, the slicing blade must be on the bottom of the disc.
-

FIT THE LID

1. Hold the lid over the jug, with the safety switch to the right of the handle.
 2. Lower the lid on to the jug.
 3. Turn the lid clockwise to bring the safety switch into the gap at the top of the handle.
 4. The controls will only operate with the lid and jug in this position.
 5. The jug will not move while the safety switch is engaged.
 6. To release the jug, you must first turn the lid to bring the safety switch to the right of the handle.
-

THE CONTROLS

O/I Press the left hand button to cancel continuous running, and to pulse the motor (run in bursts) – press **I** to start the motor, release it to stop.

USING THE CHOPPER

You may use continuous running (**I**) or pulse (**O/I**).

Continuous running is easier, if you have to add ingredients one after another.

Pulse gives better control over what is happening inside the jug.

To add ingredients while the motor is running:

1. Lift the pusher out of the tube.
 2. Add the ingredients via the tube.
 3. Replace the pusher.
- If you're using just liquids, don't fill the jug past the MAX LIQUID LEVEL mark.
 - If you're using solids, or a mixture of liquids and solids, don't fill the jug past the MAX FOOD LEVEL mark.

USING THE SLICING/GRATING DISC

1. Press **I** to run the motor continuously.
 2. Remove the pusher, and drop the ingredients down the tube.
 3. Replace the pusher, and use it to push the ingredients gently down the tube.
 4. Don't use fingers or cutlery to push food down the tube – only the pusher.
 5. The blade(s) on top of the disc will slice or grate the food into the jug.
- Don't let the jug get more than about half full – stop and empty it.

CARE AND MAINTENANCE

1. Switch the appliance off and unplug it.
 2. Wipe the outside of the motor unit with a clean damp cloth.
 3. Hand wash the removable parts.
- If you use a dishwasher, the harsh environment inside the dishwasher will affect the surface finishes.
 - The damage should be cosmetic only, and should not affect the operation of the appliance.



You may wash these parts in a dishwasher.

RECYCLING



To avoid environmental and health problems due to hazardous substances, appliances and rechargeable and non-rechargeable batteries marked with one of these symbols must not be disposed of with unsorted municipal waste. Always dispose of electrical and electronic products and, where applicable, rechargeable and non-rechargeable batteries, at an appropriate official recycling/collection point.

SERVICE

If you ring Customer Service, please have the Model Number to hand, as we won't be able to help you without it. It's on the rating plate (usually underneath the product).

The product isn't user-serviceable. If it's not working, read the instructions, check the plug fuse and main fuse/circuit breaker. If it's still not working, consult your retailer.

If that doesn't solve the problem – ring Customer Service – they may be able to offer technical advice.

If they advise you to return the product to us, pack it carefully, include a note with your name, address, day phone number, and what's wrong. If under guarantee, say where and when purchased, and include proof of purchase (till receipt). Send it to:

Customer Service

Spectrum Brands (UK) Ltd

Fir Street, Failsworth, Manchester M35 0HS

email: support@russellhobbs.com

telephone: 0345 658 9700 (local rate number)

Please note: If you have purchased the product within the last 6 months, please contact the retailer in the first instance to deal with any matters relating to warranty.

GUARANTEE

Defects affecting product functionality appearing within the guarantee period will be corrected by replacement or repair at our option provided the product is used and maintained in accordance with the instructions. Your statutory rights are not affected.

Guarantee period = 2 years from first retail purchase.

To claim an extra 1 year guarantee, register your product online within 28 days of purchase.

Register at: uk.russellhobbs.com/product-registration

Consumables are guaranteed only for their recommended lifecycle. Replacement/Spare parts* are excluded and are only covered by a 1 year warranty.

* Examples include filters, removable grill plates, drip trays/crumb trays etc.

ONLINE

www.russellhobbs.com for more products